

These are the notes referred to on the following official copy

The electronic official copy of the title plan follows this message.

Please note that this is the only official copy we will issue. We will not issue a paper official copy.

This official copy was delivered electronically and when printed will not be to scale. You can obtain a paper official copy by ordering one from HM Land Registry.

This official copy is issued on 09 August 2023 shows the state of this title plan on 09 August 2023 at 15:49:24. It is admissible in evidence to the same extent as the original (s.67 Land Registration Act 2002). This title plan shows the general position, not the exact line, of the boundaries. It may be subject to distortions in scale. Measurements scaled from this plan may not match measurements between the same points on the ground. This title is dealt with by the HM Land Registry, Telford Office .

© Crown copyright. Produced by HM Land Registry. Reproduction in whole or in part is prohibited without the prior written permission of Ordnance Survey. Licence Number 100026316.

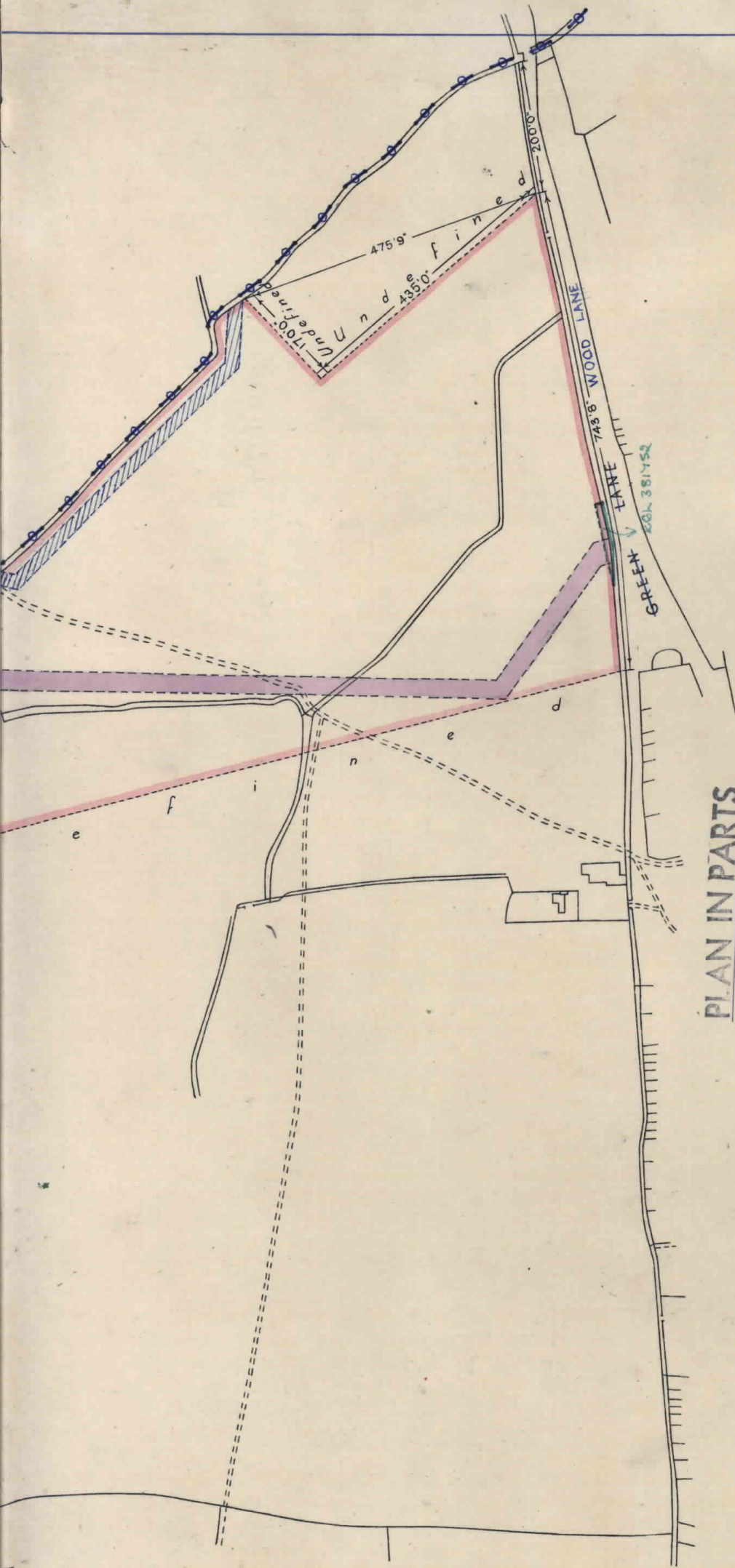

PLAN IN PARTS.
PART 1

NLXXIX.13. NLXXIX.14.

H. M. LAND REGISTRY

Filed Plan of Title No. **EX 21411**

Scale $\frac{1}{2500}$

GREATER LONDON.



The undefined boundaries of this land are subject to revision on survey after the erection of fences

NOTE: This registration is with General Boundaries only.

NW

NLXXIX.9 | NLXXIX.10

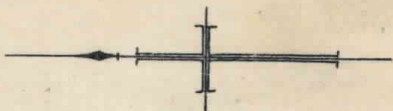

C R O W
L A N E

BAGENHAM PARISH
BOROUGH OF BARKING

Undefined

ROMFORD PARISH
BOROUGH OF HAVERING

Note: This area edged with red has been removed to part 2 of the filed plan and is shown at a larger scale and edged with red thereon.

NLXXIX.9
NLXXIX.13

NLXXIX.10
NLXXIX.14

TEMPLE

GRAY AVENUE

AVENUE

H.M. LAND REGISTRY

TITLE NUMBER

EX21411

ORDNANCE SURVEY
PLAN REFERENCE

TQ 4987

SECTION

Scale
1/1250

GREATER LONDON

BOROUGH OF BARKING AND DAGENHAM

© Crown copyright



PLAN IN PARTS
PART 2



EX 21411

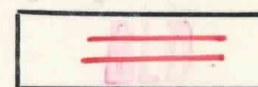

Sent to Field		Removals from Title									
Title No.	Date	Title No.	Date	Title No.	Date	Title No.	Date	Title No.	Date	Title No.	Date
		EGL 109124	7-Jan-82	EGL 122977	21-10-82	EGL 289334	30.9.91				
		EGL 110248	12-Feb-82	EGL 123808	9-11-82	EGL 296386	23.10.91				
		EGL 110567	24-Feb-82	EGL 124896	6-12-82	EGL 312330	19-7-93				
		EGL 111654	8-Mar-82	EGL 125564	21-12-82	EGL 313938	3-9-93				
		EGL 111700	19-Mar-82	EGL 125644	23-12-82	EGL 351127	23-10-96				
		EGL 112946	15-April-82	EGL 126004	7-1-83	EGL 381840	14.12.98				
		EGL 113782	30-April-82	EGL 126928	31-1-83	WITH 100100-100 HAND ADDED TO RQIN 381 1952					
		EGL 116690	29.6.82	EGL 128188	8-3-83						
		EGL 116580	25.6.82	EGL 136074	7-11-83	EGL 383946	29.1.99				
		EGL 117473	14.7.82	EGL 140996	4-4-84	EGL 397428	10-11-99				
		EGL 117687	16.7.82	EGL 141128	13-4-84						
		EGL 118507	29-7-82	EX 303765	21-11-84	YES EX PAFI					
		EGL 120551	3-9-82	EGL 217577	17.5.88						
		EGL 120813	7-9-82	EGL 219506	17-6-1988						
		EGL 121929	29-9-82	EGL 225500	8-9-1989						
		EGL 122612	14.10.82	EGL 238456	3-3-1989						
		EGL 122905	21-10-82	EGL 271550	24.8.1990						

MAP SECTION REFERENCE(S): TQ 4987 A+P

LEGAL STAFF REQUIREMENTS

References required on new title filed plans for T.P.'s and absolute D.F.L.'s falling within:

(a)

Note:- There is no EP or Corres File
at this stage.

(b) So far as affected by:

No references required (at this stage for):

Additional notes required on Certificates in Form 102:

Additional Notes

Lease Nos. Used

PL 7 Sent.....

Estate Plans Approved

Solicitors

Messrs.

Ref.....

Telephone